

Standard Temperature Data Logger

-90 °C to +140 °C

- + Collects and stores temperature information in the internal memory
- + Recover the data through the docking station using XpertLog Software
- + ITS-90 calibration coefficients are stored in the internal memory
- + Complies with FDA 21 CFR Part 11
- + Network ready: multiple users, centralized, server database, active directory authentication

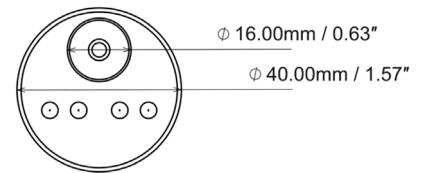
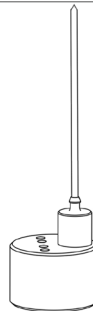
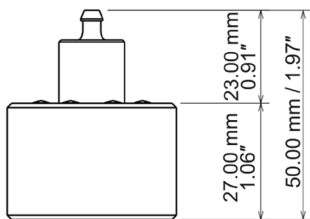

Sensor type	4 wires PT-100
- rigid	150 mm (6")
- customized	available
- sensor size	1.5 x 8 mm (0.06 x 0.315")
- cross section	1.77 mm ² (0.0027 inch ²)
Operating Range	
- body	-90 °C to +140 °C
- sensor	-90 °C to +140 °C
Accuracy	±0.1°C from -90 to 140°C
Resolution	0.01°C
Memory capacity	32,000 data points
Memory type	non volatile
Sampling rate	1 sec to 24 hours
Internal clock drift	4 sec / 24 h @ 23°C
Mechanical	
- material	Peek 1000 - FDA compliant
- enclosure	IP-68
- weight	50 g (1.76 oz)
- diameter	40.0 mm (1.57")
- height	50.0 mm (1.97")
Power	1 x Lithium batteries, 0.35 g/each Lithium content classified UN3091 under IATA DGR section 3.9.2.6 compliant with ICAO/IATA packing instructions 970,user replaceable
Battery lifetime	Up to 12 months, based on usage
Docking station	USB to computer 4, 8, 12 and 20 ports available Programs and reads unlimited number of loggers
Calibrations	Factory Calibrations: traceable NIST/COFRAC - ITS-90 coefficients stored in the internal memory User Calibrations: close loop calibration using XpertLog® software
Certification	Health Safety: EN 60950-1 / 2006 EMC: EN 60601-1-2 / 2007

Order Reference
GMPL

Standard Calibration Points

- -80°C
- 0°C
- 140°C

